

PCAM-890-AHD



**120 Degree, AHD Camera  
with various mounting  
options**

**User Manual**



## Introduction

Thank you for purchasing your EchoMaster automotive camera.

The following part numbers are supported:

### ► PCAM-890-AHD

EchoMaster cameras are designed to improve safety when driving by providing high quality images of surrounding areas and obstacles in the vicinity of the vehicle. They will also improve vehicle maneuvering capability by displaying blind spots not normally visible to the driver.

Please ensure you read and understand all aspects of this manual before installing or using your EchoMaster camera. Choose a suitable mounting place dependent on the application. Ensure that there are no wiring harnesses or hoses/pipes located behind the panel before drilling.

## Key Features

- HD CCD Sensor
- Operates at 0.05 LUX
- 720p at 30fps
- Interior Windshield Mount
- 120 Degree Horizontal Viewing Angle
- 3 Year Warranty

## Box Contents

- Camera
- Metal Mounting Bracket
- Hardware Pack
- User Manual

## Metal Bracket Installation

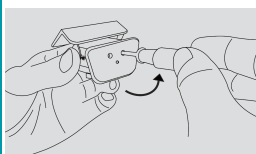

1. Remove the windshield mount by removing the two screws on the back of the mount.

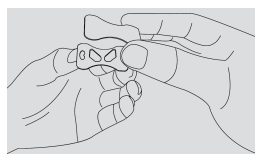

2. Remove the adhesive backing and apply the 3M pad to the metal bracket.

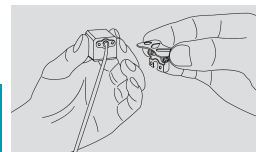

3a. Secure the metal bracket to the back of the camera.

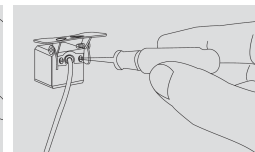

3b. Tighten the screws on the back to finish attaching the metal bracket.

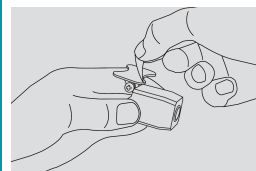

4. Clean the mounting surface and remove the remaining adhesive backing.

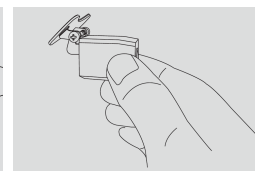

5. Adhere the camera and mount to the desired mounting location.

## Wiring Diagram and Pin Out

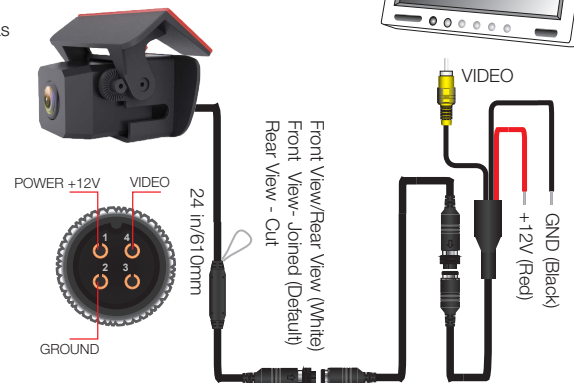

Extension and Power Adapter Harness sold separately

	PCAM-890-AHD
<b>Sensor Type</b>	HD CCD Sensor
<b>LEDs</b>	N/A
<b>Minimum Illumination</b>	0.05 LUX
<b>Viewing Angle</b>	120 Degrees Horizontal
<b>Parking Lines</b>	No
<b>Mirror Image</b>	Yes
<b>Normal View</b>	Yes
<b>Water/Debris-Proof</b>	IP67
<b>Audio</b>	No
<b>Power Supply</b>	12V(DC)
<b>Current</b>	<100mA
<b>Working Temperature</b>	-20°C ~ +60°C
<b>Video Format</b>	NTSC
<b>Framerate</b>	30fps
<b>Resolution</b>	720 x 480

## Windshield Bracket Installation

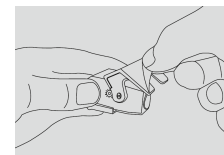

1. Remove the adhesive backing.

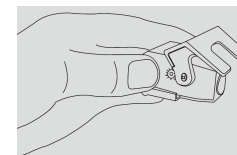

2. Clean the mounting surface and adhere the camera in place.

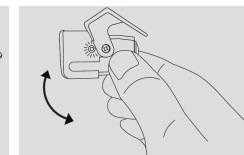

3. Adjust the camera angle to the desired view.

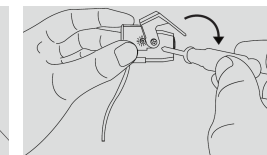

4. Tighten the side screws to lock the camera angle in place.

Loosen the screws on the side that holds the camera to the mount to adjust the camera angle. Tighten the screws to lock in place.

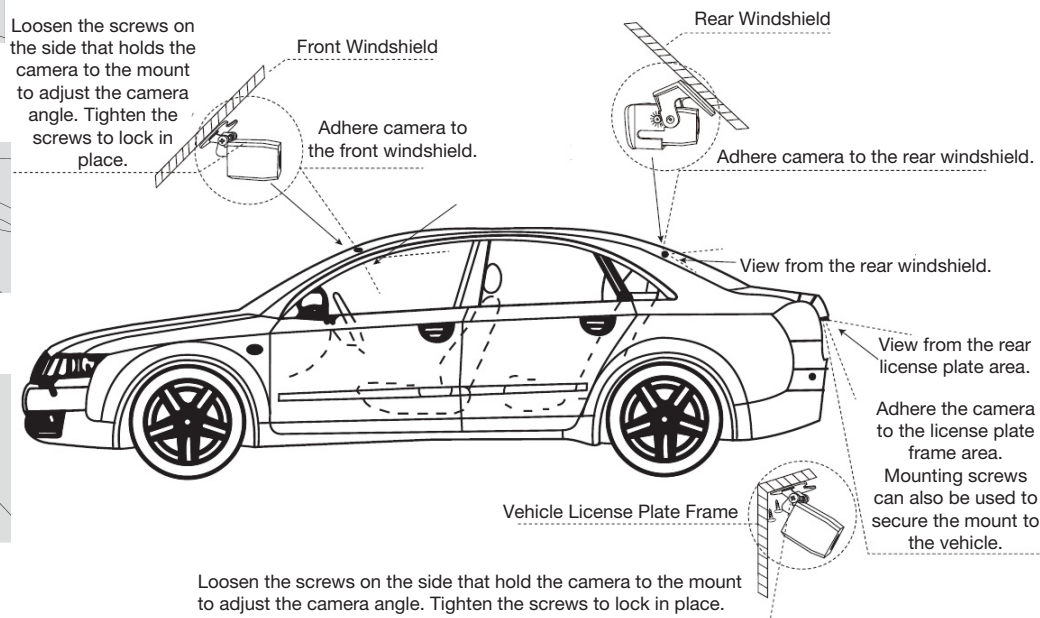

REV DC011024

EchoMaster.com  
EchoMaster is a Power Brand of Stinger.

**Stinger**

15500 Lightwave Drive, Suite 202  
Clearwater, Florida 33760  
email - support@stingersolutions.com  
phone - 1 (727) 592-5991

